

# FLEX

## TWO-CHANNEL PLUG IN RECEIVER 800 USERS

Freq. 433.920 MHz (Cod. 23120430)

Freq. 868.300 MHz (Cod. 23120435)

### Generalities

The 433.920 MHz and/or 868.300 Mhz receiver module (RX) is compatible with the following SEA transmitters: **SMART** series, **HEAD** series, **HEAD EasyCopy** series.

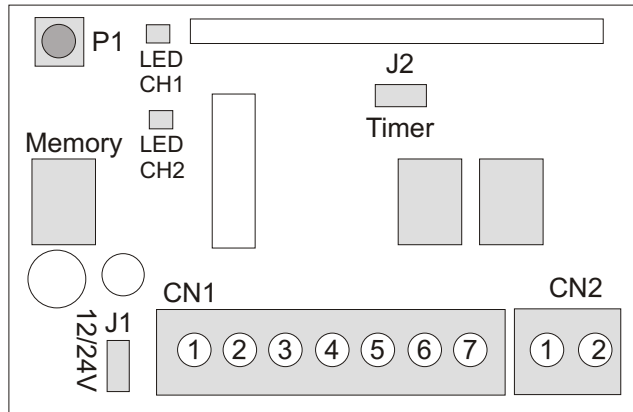

Module Receiver Package

Content:

- Electronic circuit
- Plastic container
- Instructions
- Accessories for installation

### Technical Specifications

Power supply:	12/24 ~ / ===
Absorption:	15mA without working
Receiving frequency :	433.920Mhz or 868.300Mhz
Sensitivity:	-100 dB
Code:	64 bit digital or dip switch
Number of codes which can be memorized:	800
Number of channels:	2
CH1 Output:	N.O. Free Contact
CH2 Output:	N.O./N.C. Free Contact
Working temperature:	-15°C / +60°C
Storage temperature:	-40°C / +80°C
Dimensions:	46 x 65 mm
Humidity:	from 5% to 90% no condensation

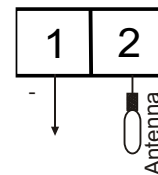
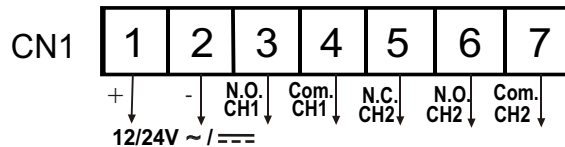

<b>Jumper selection</b>	<b>Power Supply Selection</b> <i>J1 Connected = 12V~ / ===</i> <i>J1 Opened = 24V~ / ===</i>	<b>Timer</b> <i>J2 Connected = CH2 2 min. timed</i> <i>J2 Not inserted = CH2 not timed</i>
-------------------------	--	--

### Radiocontrol learning on Channel 1

- Push P1 button to have access to the Programming modality
- CH1 led will switch on
- Push the selected button on the transmitter
- CH1 led will flash twice to confirm the memorization and it will stay switch on until it will receive a new code (other transmitter).
- Memorize other radiocontrols or push P1 twice to exit from the Programming modality.

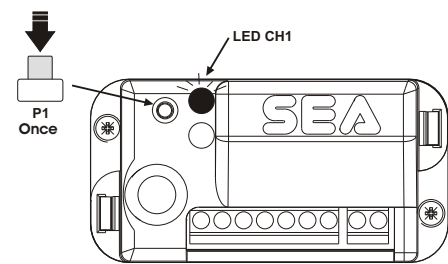

### Radiocontrol learning on Channel 2

- Push P1 button twice to have access to the Programming modality
- CH2 led will switch on
- Push the selected button on the transmitter
- CH2 led will flash twice to confirm the memorization and it will stay switch on until it will receive a new code (other transmitter).
- Memorize other radiocontrols or push P1 twice to exit from the Programming modality.

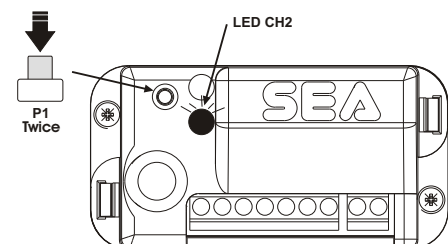

### Notice

- By using DIP SWITCH radiocontrols programmed with the same codes it is sufficient to memorize only one transmitter.
- If a code which is already inside the memory of the receiver is programmed, it will be deleted (4 flashes). In the programming phase be careful to send only one impulse with the transmitter.

### Radiocontrol deleting

- By pushing P1 button, select the channel where the radiocontrol has been memorized (CH1 or CH2 led switched on).
- Push the button which must be deleted on the radiocontrol.
- The led will flash four times to confirm the deleting.
- Push P1 or wait 10 seconds to exit from the deleting programming (leds switched off).

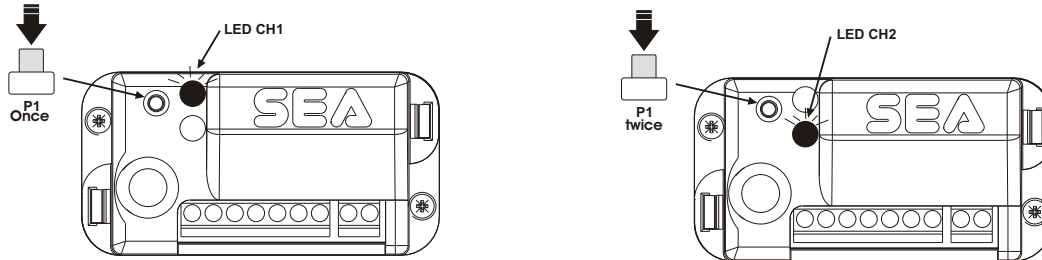

### Deleting of the whole memory

- Push P1 button for three times. Both leds will switch on.
- Push P1 button and keep it pushed inside three seconds.
- Both leds will start to flash (DELETING).
- Keeping P1 pushed, wait until the leds will switch off (about 10 seconds).
- Both the leds will flash for 6 times as confirmation that the deletion of the memorized codes has been done

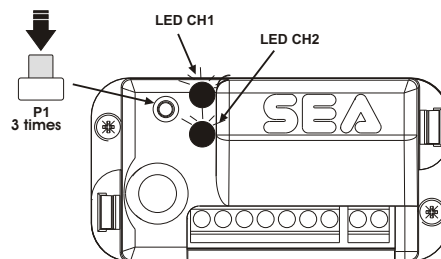

### Memory managing and copying

It is possible to manage and to execute security copies contained inside the memory. This memory must be take off from the receiver and put inside the related connector of PALM EasyCopy.

## Installation

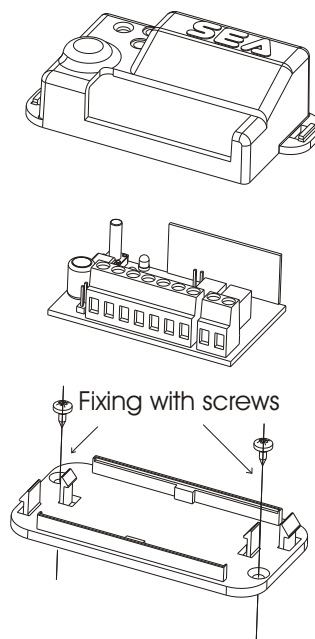

## SPARE PARTS

To obtain spare parts contact:

SEAs.r.l. ZONA Ind.le, 64020 S.ATTO Teramo Italia

## DESTINATION OF USE

The 433.920 MHz and/or 868.300 Mhz receiver has been planned to be used exclusively as a receiver of digital data with a frequency of 433.920 MHz and/or 868.300 Mhz sent by a radio transmitter from SEA S.r.l. which transmits on the same frequency and which is codified to be interfaced with the 433.920 MHz and/or 868.300 Mhz receiver. The receiver must be used only as a generator of commands to be transmitted to a SEA s.r.l. automation unit for doors, gates and leaves and it must be supplied with safety tension.

## SAFETY AND ENVIRONMENTAL COMPATIBILITY

We recommend not to spoil the environment with product and circuit packing material.

## REQUISITES OF CONFORMITY

The 433.920 MHz and/or 868.300 Mhz receiver conforms to the following:

1999/5/CE (Direttiva R&TTE)

ETS 300 683

ETS 300 220

EN 60065

## STORAGE

STORAGE TEMPERATURES			
T <sub>min</sub>	T <sub>max</sub>	Humidity <sub>min</sub>	Humidity <sub>max</sub>
- 40°C ↓	+ 80°C ↓	5% no condensation	90% no condensation

When being transported this product must be properly packaged and handled with care.

## DISTRIBUTION COUNTRIES

SEAS.r.l. will sell 433.920MHz receiver and/or 868.300MHz receiver in the EU countries.

## MAINTENANCE AND OUT OF SERVICE

The decommission and maintenance of 433.920 MHz receiver and/or 868.300 MHz receiver must only be carried out by specialised and authorised personnel.

## LIMIT OF GUARANTEE

The 433.920 MHz receiver and/or 868.300 MHz receiver are guaranteed for a period of 24 months. The guarantee period starts from the date stamp printed on the unit. The 433.920 MHz receiver and/or 868.300 MHz receiver guarantee will be void if the unit has been incorrectly installed, not used for the purpose intended, tampered with or modified in any way.

The validity of this guarantee only extends to the original purchaser of the unit.

**NOTE: THE MANUFACTURER CAN NOT BE DEEMED RESPONSIBLE FOR ANY DAMAGE OR INJURY CAUSED BY IMPROPER USE OF THIS PRODUCT.**

*SEA reserves the right to do changes or variations that may be necessary to its products with no obligation to notice.*



### Correct Disposal of This Product (Waste Electrical & Electronic Equipment) - Europe only

(Applicable in the European Union and other European countries with separate collection systems)

This marking shown on the product or its literature, indicates that it should not be disposed with other household wastes at the end of its working life. To prevent possible harm to the environment or human health from uncontrolled waste disposal, please separate this from other types of wastes and recycle it responsibly to promote the sustainable reuse of material resources.

Household users should contact either the retailer where they purchased this product, or their local government office, for details of where and how they can take this item for environmentally safe recycling.