

I Copricolonna tondo grezzo con bordo

UK Welding round cap with flange - black



D Anschweißbare Rundekappen mit flansch, roh

F Chapeau noir avec bords à souder sur tube rond

E Cubrecolumna circular non cincado

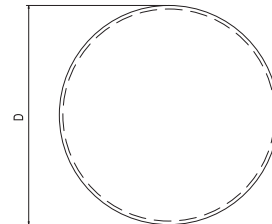
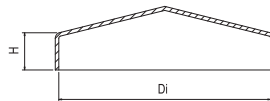
RUS Крышка из черного металла под сварку на прямоугольную трубу



Articolo - Article		D	Di	H		
Riferimento - Reference		∅		mm	N°	
CAP 1TG	PG 30 11 TX	33	30	10	200	4,6
CAP 2TG	PG 33 11 TX	36	33	10	200	4,7
CAP 3TG	PG 42 11 TX	45	42	10	100	3,9
CAP 4TG	PG 48 13 TX	51	48	10	100	4,8
CAP 5TG	PG 60 14 TX	63	60	10	50	3,6
CAP 6TG	PG 76 14 TX	79	76	14	30	3,0
CAP 7TG	PG 90 14 TX	92	90	14	20	2,6
CAP 8TG	PG 11 14 TX	104	101	14	20	3,0
CAP 9TG	PG 12 14 TX	117	114	14	20	3,8