

palgate

SPIDER SYSTEMS



USER MANUAL

Contents

Product Description	3
Key Benefits	3
Variants	4
Spider - 50.....	4
Spider - i	5
Spider - B.....	5
Spider i-WRL	6
Spider i-WR.....	6
Spider - B-WR	7
Spider - Wiegand 26.....	7
LEDs key	8
Specifications	8
Typical wiring connection Electronic Lock:	9
Typical wiring connection to a Gate:	9
System settings by the App	10
The PalGate App installation process	10
New device setup	11
Adding a new user	11
Important Information:	11







Product Description

The Spider Systems IoT units are 4G network-based systems, enhanced with Bluetooth for access and management control. Through on board relays, users can control the unit via either a dedicated application or an easy-to-use web portal. This device seamlessly integrates with electric gates, doors, lighting systems, or any other appliance that would benefit from remote control and management.

Key Benefits

- **Remote Access** - Complete and secure control of the unit anytime, and from anywhere.
- **Peace of mind** - Ensures access even during rare cellular network downtimes.
- **"Nearby only" Feature** - Allows specific users to operate the unit only when in proximity.
- **Automatic opening** - PalGate App can operate the gate automatically when arriving at the gate by car, this feature will work only when the PalGate App is connected to a vehicle's multimedia system via Bluetooth.
- **Compact Size** - The unit has a small footprint, measuring just 80X53 mm.
- **Management and control** - using the free "PalGate" App and an easy to use management WEB portal.
- **Visual Indicators** - Features 4 LED lights (1 to indicate that the SIM is active and 3 to indicate reception strength).
- **Customizable Access** - Ability to set up multiple administrators and authorized users for tailored access and control.
- **Real time notifications** - Receive instant email or push notifications to the PalGate App.
- **Voice Control** - Voice-controlled operation via Siri or Google Assistant.
- **Customization** - Ability to set timers, events, astronomic clocks and more.
- **User Management** - Easily import and export data using Excel.
- **Programmable relay pulse width**

Variants

Model	Spider - 50	Spider - i	Spider - B	Spider i-WRL	Spider i-WR	Spider B-WR	Spider - Wiegand 26
							
Control with application IOS & Android	✓	✓	✓	✓	✓	✓	✓
Control by WEB interface	✓	✓	✓	✓	✓	✓	✓
User definition Nearby only or unlimited distance	✓	✓	✓	✓	✓	✓	✓
Excel import/export	✓	✓	✓	✓	✓	✓	✓
Schedule management control	✓	✓	✓	✓	✓	✓	✓
Supports smart remote control & Wireless vehicle detector	--	--	--	10,000	10,000	10,000	10,000
Output (N.O/N.C)	1	1	2	1	1	2	1
Input (N.O/N.C)	1	1	2	1	1	2	2
Max users	50	20,000	20,000	3	20,000	20,000	20,000
Wiegand 26 bit reader	--	--	--	--	--	--	✓
Size and Weight of package	8*5.3*2.5CM 83 gr	8*5.3*2.5CM 83 gr	8*5.3*2.5CM 83 gr	8*5.3*2.5CM 87 gr	8*5.3*2.5CM 87 gr	8*5.3*2.5CM 87 gr	8*5.3*2.5CM 87 gr
P/N							
USA	SP100	SP101	SP102	SP110	SP111	SP112	SP113
Australia	SP200	SP201	SP202	SP210	SP211	SP212	SP213
Europe	SP300	SP301	SP302	SP310	SP311	SP312	SP313

Spider - 50

USA	SP100
Australia	SP200
Europe	SP300

iOS/Android Siri support

Apple watch Google Assistant Google Home

Apple CarPlay

- Supports 50 PalGate App users
- 1 output relays (N.O./N.C.)
- 1 input channels with real-time notifications to Email and push to PalGate App
- Multiple opening methods: Proximity, App, Dialing, Siri, and Google Assistant
- Allows customization of opening distance
- Manage with a free App or user-friendly web interface*
- API integration available*
- Provides unlimited logs*
- Features timers and event scheduling
- Equipped with a programmable astronomical clock
- Capability to import and export data via Excel files
- Adjustable relay pulse width
- Compatible with 4G networks
- Operates on an input voltage of 12VDC
- Compact dimensions: 53x80 mm

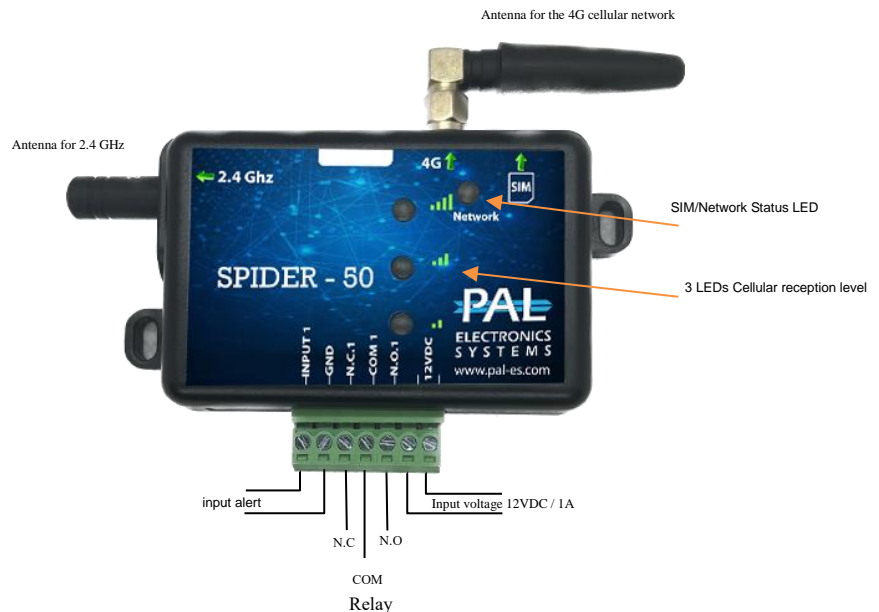

Spider - i

USA	SP101
Australia	SP201
Europe	SP301

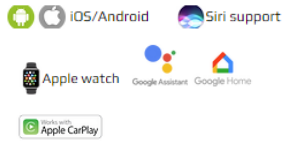

- Supports unlimited PalGate App users
- 1 output relays (N.O./N.C.)
- 1 input channels with real-time notifications to Email and push to PalGate App
- Multiple opening methods: Proximity, App, Dialing, Siri, and Google Assistant
- Allows customization of opening distance
- Manage with a free application or user-friendly web interface*
- API integration available*
- Provides unlimited logs*
- Features timers and event scheduling
- Equipped with a programmable astronomical clock
- Capability to import and export data via Excel files
- Adjustable relay pulse width
- Compatible with 4G networks
- Operates on an input voltage of 12VDC
- Compact dimensions: 53x80 mm

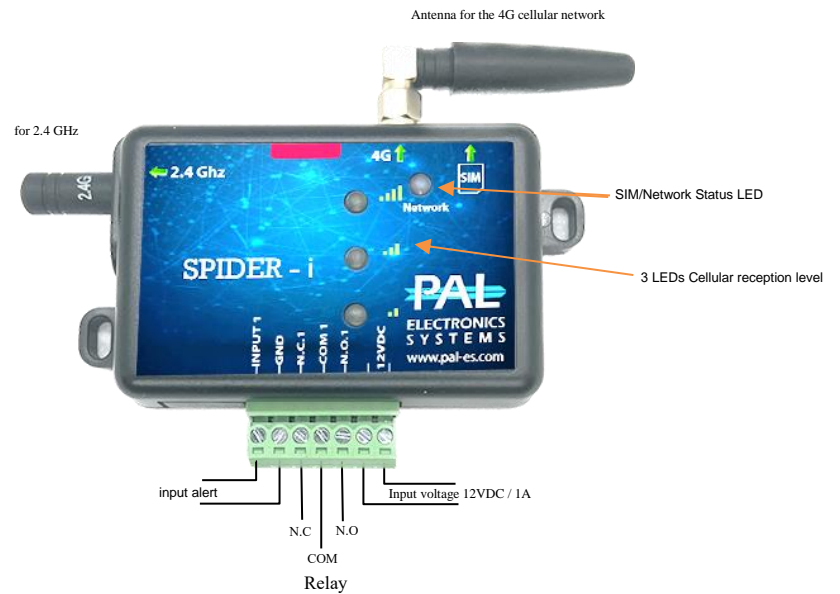

Spider - B

USA	SP102
Australia	SP202
Europe	SP302

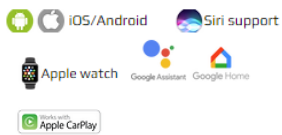

- Supports unlimited PalGate App users
- 2 output relays (N.O./N.C.)
- 2 input channels with real-time notifications to Email and push to PalGate App
- Multiple opening methods: Proximity, App, Dialing, Siri, and Google Assistant
- Allows customization of opening distance
- Manage with a free application or user-friendly web interface*
- API integration available*
- Provides unlimited logs*
- Features timers and event scheduling
- Equipped with a programmable astronomical clock
- Capability to import and export data via Excel files
- Adjustable relay pulse width
- Compatible with 4G networks
- Operates on an input voltage of 12VDC
- Compact dimensions: 53x80 mm

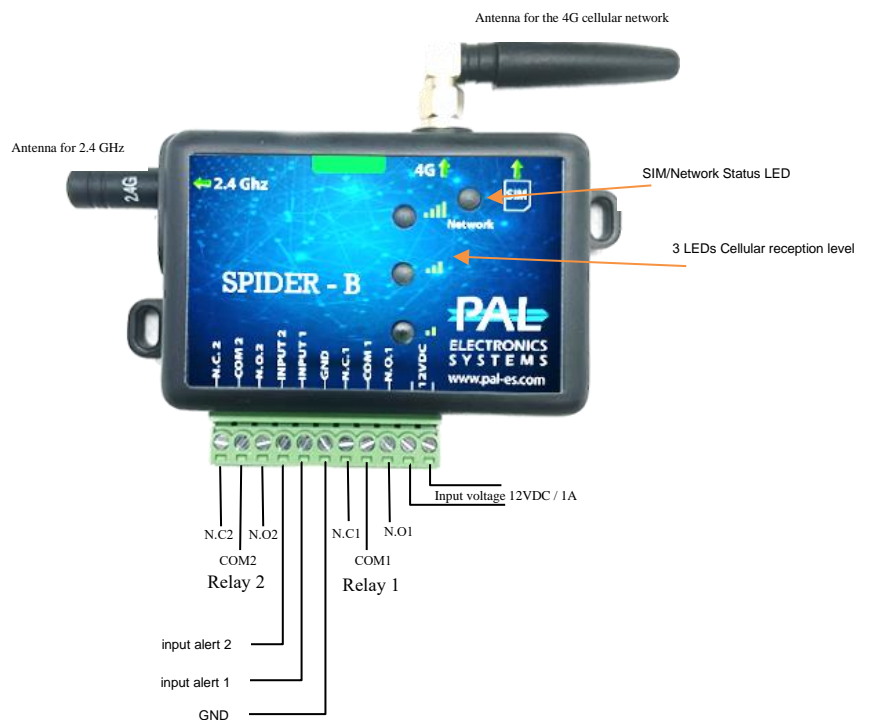

Spider i-WRL

USA	SP110
Australia	SP210
Europe	SP310

- Supports 3 PalGate App users
- 1 output relays (N.O./N.C.)
- 1 input channels with real-time notifications to Email and push to PalGate App
- Wireless receiver 433Mhz.
- Multiple opening methods: Proximity, App, Dialing, Siri, and Google Assistant
- Allows customization of opening distance
- Manage with a free application or user-friendly web interface*
- API integration available*
- Provides unlimited logs*
- Features timers and event scheduling
- Equipped with a programmable astronomical clock
- Capability to import and export data via Excel files
- Adjustable relay pulse width
- Compatible with 4G networks
- Operates on an input voltage of 12VDC
- Compact dimensions: 53x80 mm

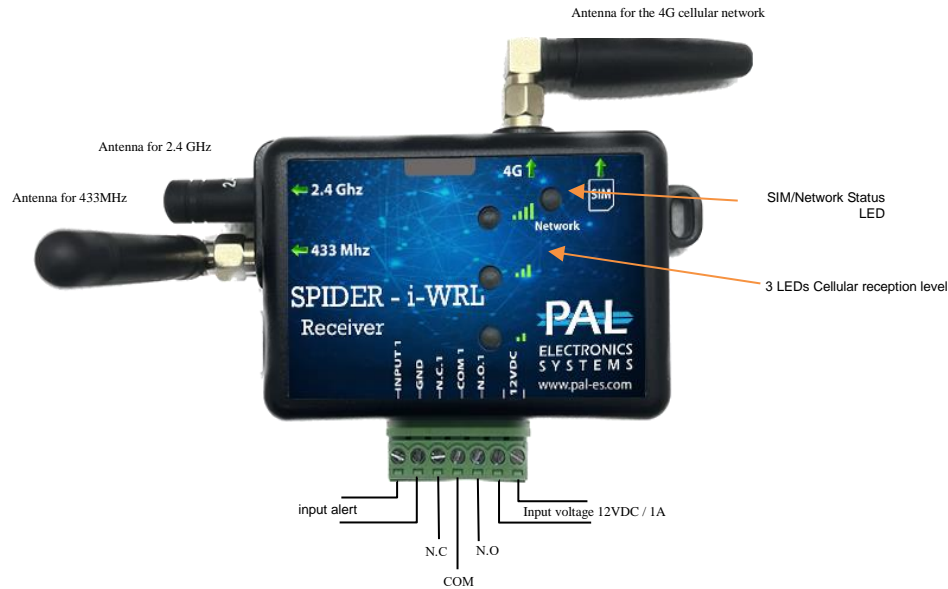

Spider i-WR

USA	SP111
Australia	SP211
Europe	SP311

- Unlimited PalGate App users
- 1 output relays (N.O./N.C.)
- 1 input channels with real-time notifications to Email and push to PalGate App
- Wireless receiver 433Mhz.
- Multiple opening methods: Proximity, App, Dialing, Siri, and Google Assistant
- Allows customization of opening distance
- Manage with a free application or user-friendly web interface*
- API integration available*
- Provides unlimited logs*
- Features timers and event scheduling
- Equipped with a programmable astronomical clock
- Capability to import and export data via Excel files
- Adjustable relay pulse width
- Compatible with 4G networks
- Operates on an input voltage of 12VDC
- Compact dimensions: 53x80 mm

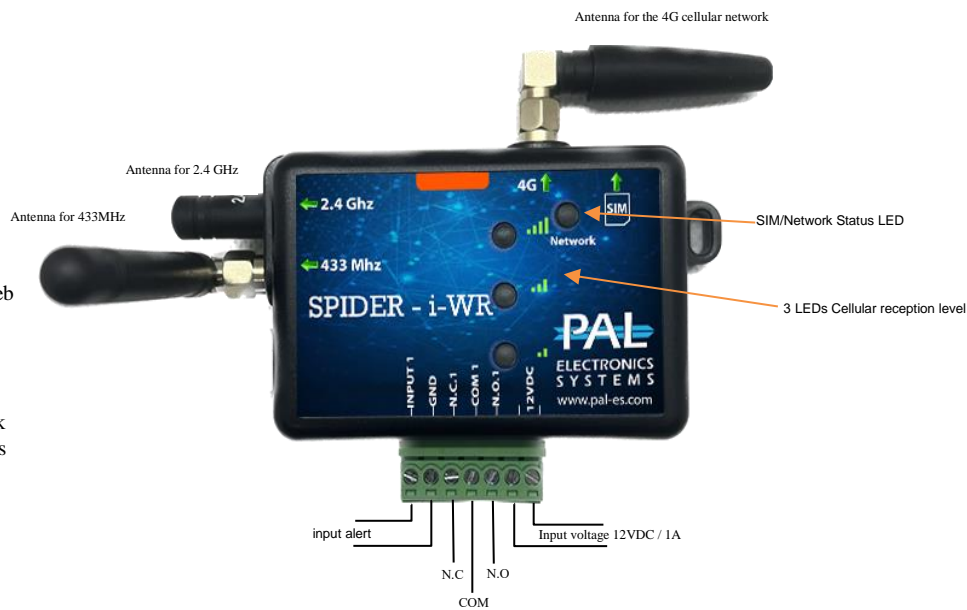

Spider – B-WR

USA	SP112
Australia	SP212
Europe	SP312

- Unlimited PalGate App users
- 2 output relays (N.O./N.C.)
- 2 input channels with real-time notifications to Email and push to PalGate App
- Wireless receiver 433Mhz.
- Multiple opening methods: Proximity, App, Dialing, Siri, and Google Assistant
- Allows customization of opening distance
- Manage with a free application or user-friendly web interface*
- API integration available*
- Provides unlimited logs*
- Features timers and event scheduling
- Equipped with a programmable astronomical clock
- Capability to import and export data via Excel files
- Adjustable relay pulse width
- Compatible with 4G networks
- Operates on an input voltage of 12VDC
- Compact dimensions: 53x80 mm

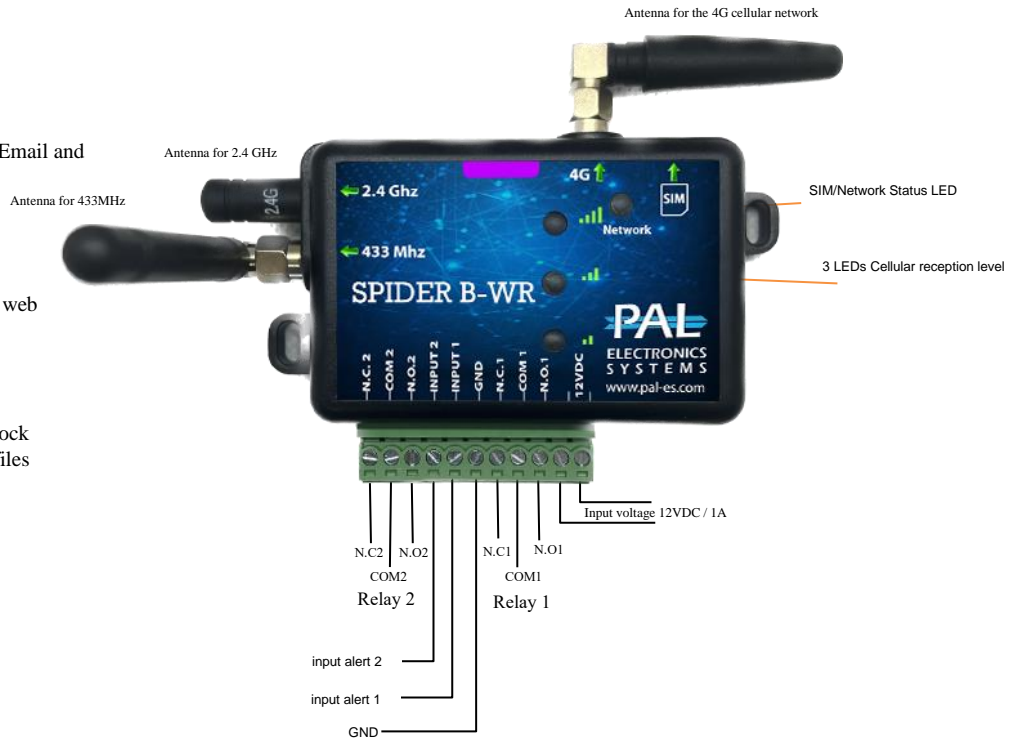

Spider – Wiegand 26

USA	SP113
Australia	SP213
Europe	SP313

- Unlimited PalGate App users
- 1 output relays (N.O./N.C.)
- 2 input channels with real-time notifications to Email and push to PalGate App
- Wireless receiver 433Mhz.
- Wiegand 26 bit reader.
- Multiple opening methods: Proximity, App, Dialing, Siri, and Google Assistant
- Allows customization of opening distance
- Manage with a free application or user-friendly web interface*
- API integration available*
- Provides unlimited logs*
- Features timers and event scheduling
- Equipped with a programmable astronomical clock
- Capability to import and export data via Excel files
- Adjustable relay pulse width
- Compatible with 4G networks
- Operates on an input voltage of 12VDC
- Compact dimensions: 53x80 mm

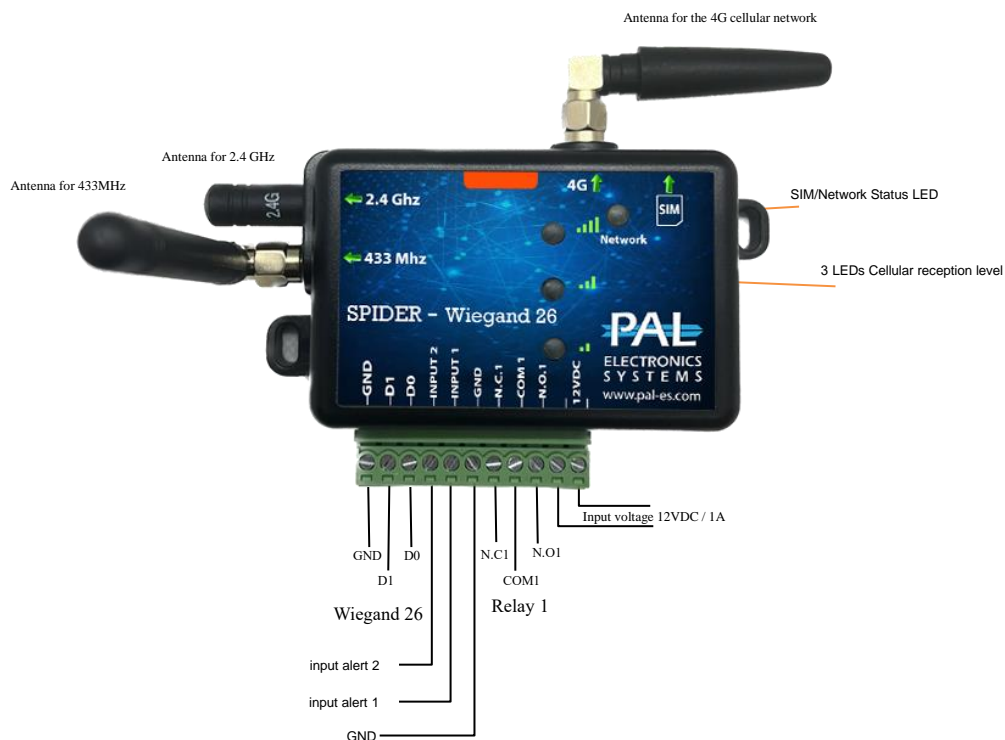

LEDs key:

SIM/Network LED

Fast Flashing: System is booting

Slow Flashing: Module is searching for a cellular network

All LEDs Flashing: SIM card not recognized

LED 1

Blinking Twice: Connecting to the internet

Blinking Four Times: Connecting to the servers

Signal Strength

4G Signal Strength Indicator

LED #1 ON: Low signal

LED #1 and #2 ON: Good signal

LED #1, #2, and #3 ON: Very good signal

Specifications:

Supply Voltage Range: 12-24V DC

Average Standby current consumption: ~70mA

Relay Contact Current Rating: 1A, 30V AC/DC (Resistive)

Antenna: 50Ω SMA Antenna interface

Temperature Range: -20°C to +70°C (-4°F to +158°F).

Exterior Dimensions: 53mm x 80 mm (2.09 in. x 3.15 in).

Net Weight: 87 gr (3.07 ounces)

Voice Support: VoLTE

Frequency Bands:

U.S.A Market (SP1XX): 4G bands: B2, B4, B12, B66

Australia Market (SP2XX): 4G bands: B1, B3, B5, B8, B9, B18(B26), B19, B28

Europe Market (SP3XX):

4G: B1, B3, B7, B8, B20, B28A

3G: B1, B3, B8

2G: B3, B8

Typical wiring connection to an Electronic Lock:

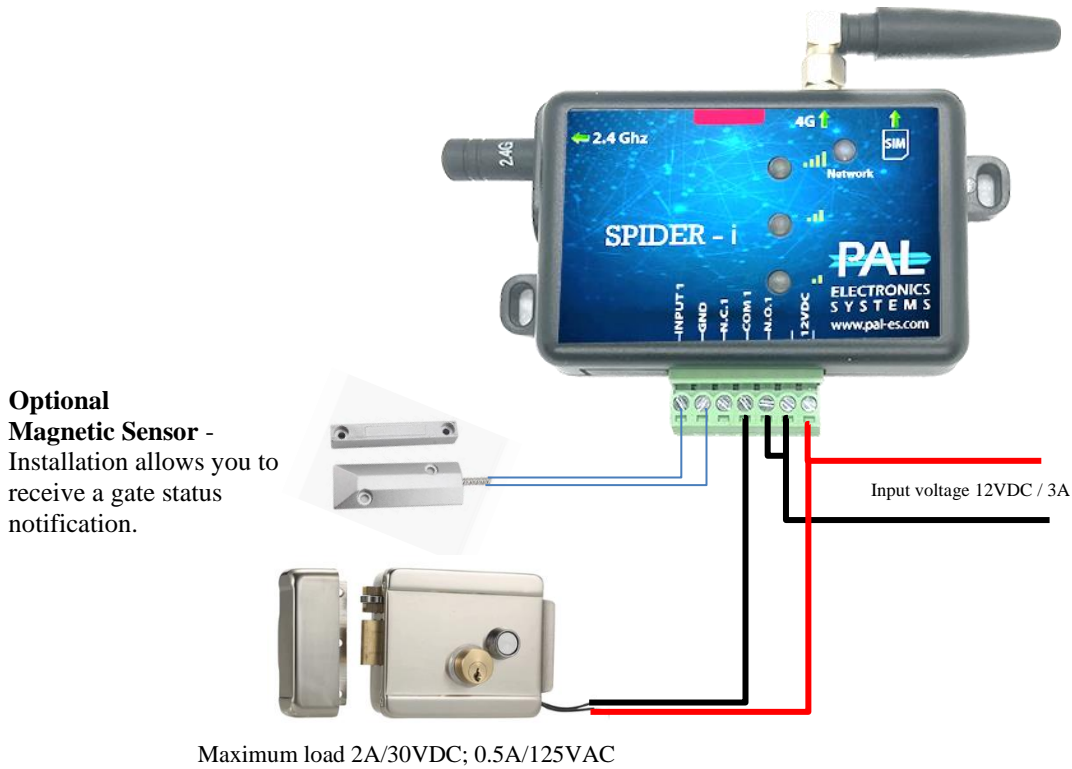

Typical wiring connection to a Gate:

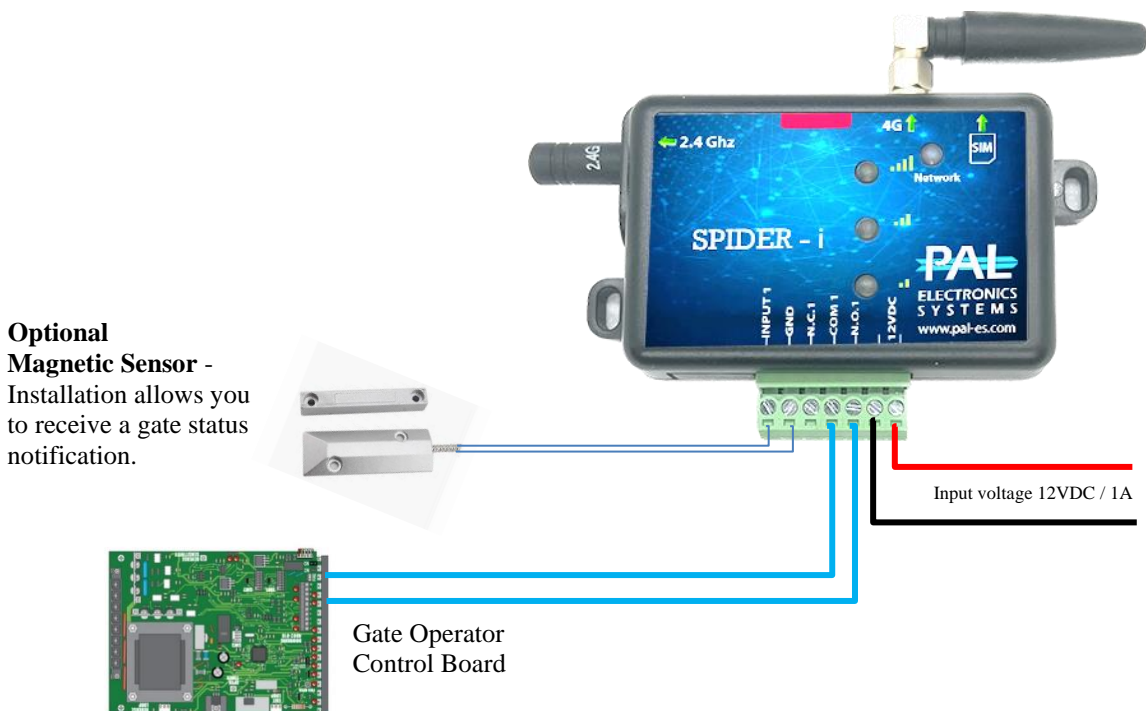

System settings using the PalGate App

You may download our App from either the Apple App Store or from Google Play by searching for the name "PalGate". If you prefer, you can access a direct link by scanning the QR codes below:

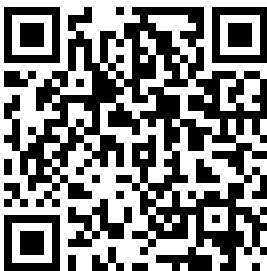

The PalGate App installation process

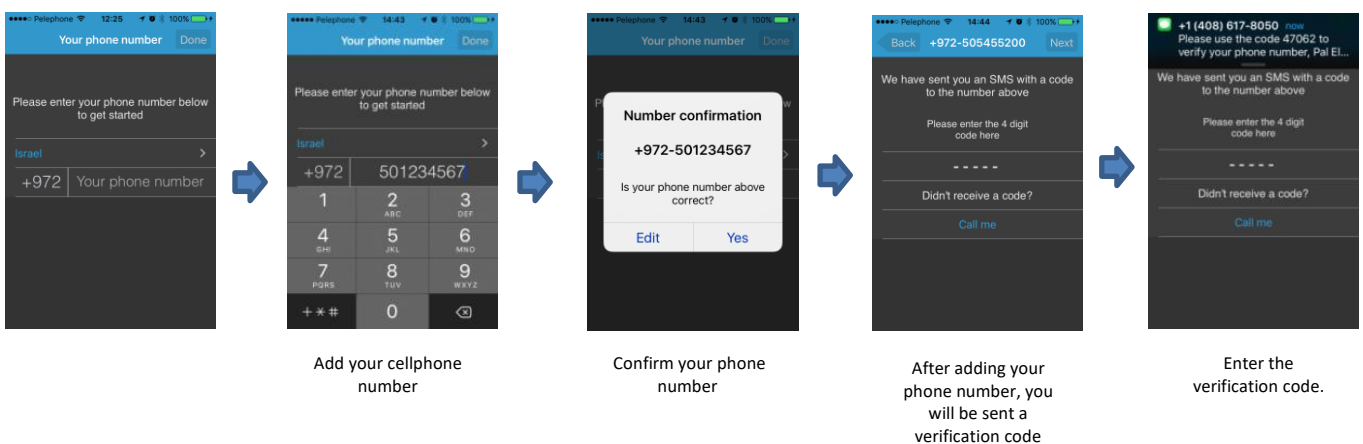

New device setup

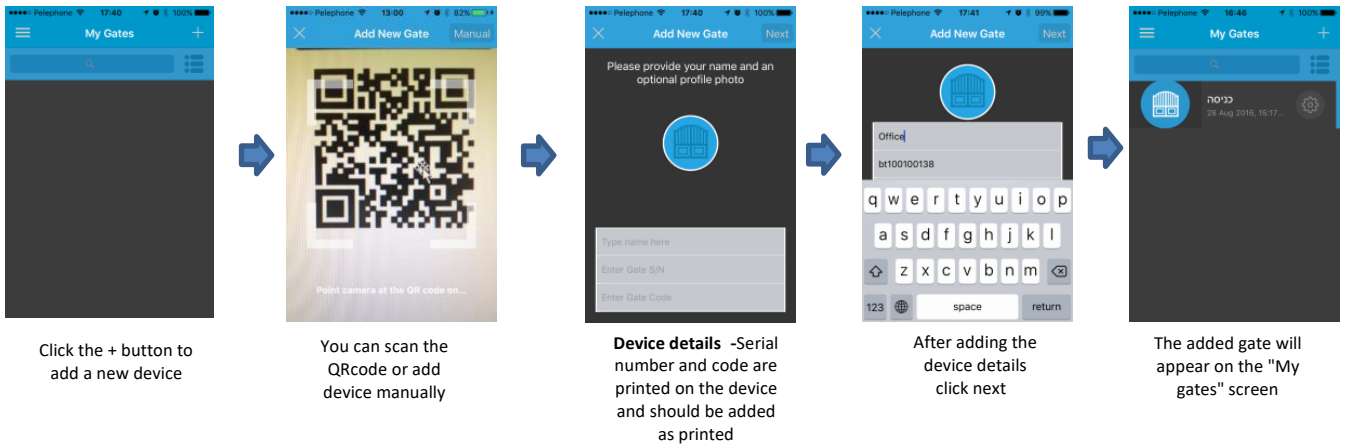

Add a new user

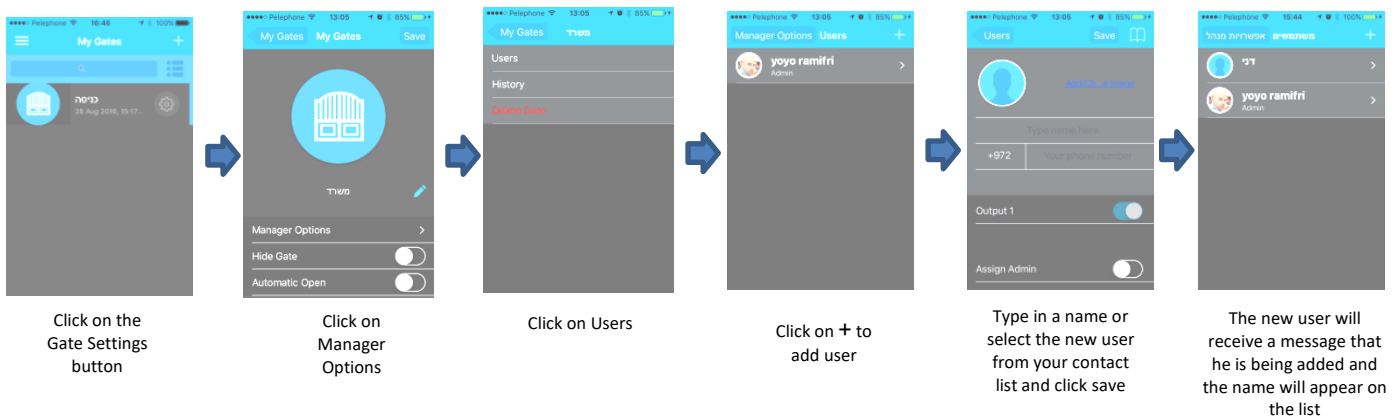

Important Information for optimal operation:

- **Installation:** If the device will be installed in a metal cabinet, the installer must connect an external antenna to the device that will reach the outside of the cabinet.
- **Power Requirements:** The unit requires a stable power source of 12Vdc/1A.
- **Environment:** Protect the unit from excessive humidity and prevent insect infiltration.
- **Network Compatibility:** The Spider Systems unit operates using 4G and Bluetooth technology. For optimal performance, prior to installation ensure the availability of acceptable 4G signal strength in the installation area. Pal Electronics Systems Ltd. is not responsible for the quality of cellular network coverage. It is the installer's/user's responsibility to ensure adequate 4G reception in the area.
- **Maintenance:** Any maintenance or repairs should only be conducted by authorized installers.

ptional feature. Payment may apply